

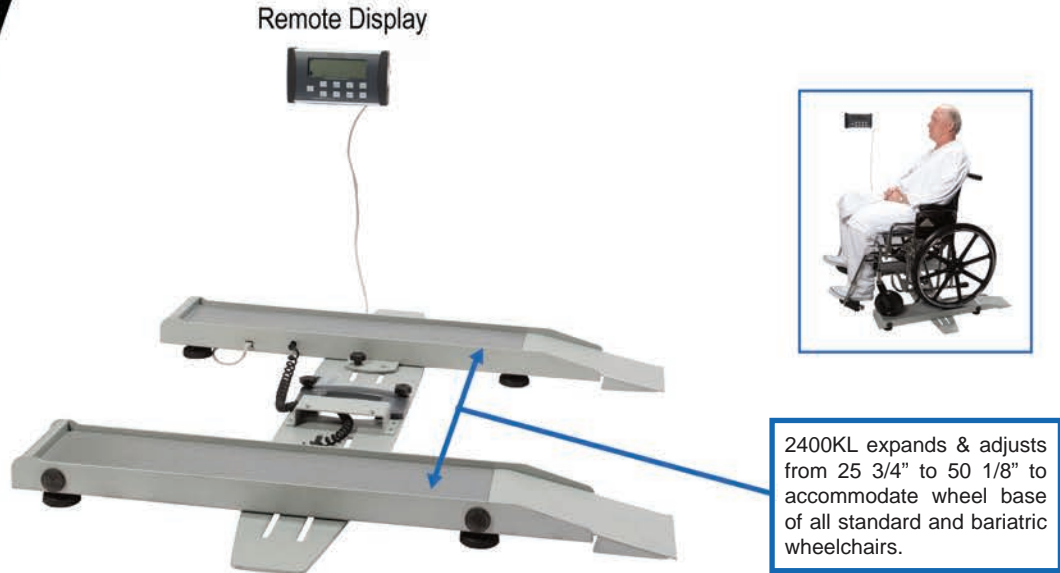

Portable

Advantages

- EMR Connectivity**
Scale has the ability to interface with a computer, EMR software or other electronic device via various Health o meter® Professional Connectivity Solutions
- Remote Display and Adjustable Tracks**
Display can be mounted on wall or placed on table, Wheelchair rails expand and adjust from 25 3/4" to 50 1/8" to accommodate all standard and bariatric wheelchairs
- Value-Added Features**
Operating functions (LB/KG Conversion, LB/KG Lock Out, BMI, Zero Out/Tare, Hold/Release, Reweight, Recall, Auto Zero, Auto Off) included at no additional cost
- Easy Mobility and Storage**
Track base folds for compact storage and easy portability
- Calculates Body Mass Index (BMI)**
Scale functions include the ability to calculate the patient's Body Mass Index (BMI)



Model	Shipping Dims. (L x W x H) / Cube	Weight (LB)	UPC Code
2400KL	46.625" x 27.875" x 8.625" / 6.42	49.25 lb	892076002695



Specifications

- Capacity: 800 lb / 363 kg
- Resolution: 0.2 lb / 0.1 kg
- Platform Size: Expands and Adjusts from 25 3/4" (654 mm) to 50 1/8" (1273 mm)
- Rail Size: 6" (w) x 40" (d) / 152 mm (w) x 1017 mm (d)
- Display: LCD, Remote Display
- Connectivity: USB
- Power Source: 110-240V adapter included, 6 AA batteries (not included)
- Functions: LB / KG Conversion, LB / KG Lock Out, Body Mass Index (BMI), Zero Out / Tare, Hold / Release, Reweigh, Auto Zero, Auto Off
- 2 Year Limited Warranty